



Coxwold, York, YO61 4AB

£315,000



Coxwold, York, YO61 4AB

STYLE – Period Cottage

HIGHLIGHTS – Sympathetically Restored and Updated with Oodles of Charm Located in Desirable Village

THREE WORDS – Chocolate Box Cottage

CHARMING COTTAGE SITUATED IN PICTURESQUE COXWOLD

Nestled in the heart of the enchanting village of Coxwold, Jasmine Cottage is a quintessential 19th-century stone-built retreat that exudes charm and character. This chocolate box cottage is perfectly positioned at the foot of the Howardian Hills, offering scenic views and a tranquil lifestyle in one of North Yorkshire's most sought-after locations.

STEP INSIDE

Step inside this lovingly updated home and be greeted by bespoke wooden double-glazed windows and doors, complemented by oil-fired central heating and a new boiler installed in 2021. The heart of the home is the bespoke kitchen, featuring base and wall-mounted cupboards and drawers, elegantly finished with granite worktops from Belgravia Stone. A Belfast sink and a newly installed range-style oven complete this culinary haven, with pretty garden views to inspire your cooking.

The open-plan dining room is a cosy space, perfect for intimate gatherings, with French doors that open onto an enclosed cottage garden. The sitting room invites relaxation with its comfy sofas and a lovely log-burning stove, ideal for cosy evenings in. A utility and storage room add practicality to this charming abode.





UPSTAIRS

Upstairs, the generous master bedroom with pine fitted wardrobe boasts a window seat overlooking the picturesque village of Coxwold, there is a second bedroom with garden views. The bathroom has a delightful country vibe, featuring a cast iron bath, new tiling, and flooring, along with a fitted cupboard for added convenience.

OUTSIDE

Outside, the south-facing walled cottage garden is a private oasis, perfect for alfresco dining and summer BBQs. Borders of shrubs, plants, and flowers create a serene backdrop, while a brick store provides useful storage. Off-street parking is conveniently accessed from Back Lane.

Coxwold offers a vibrant local life with a country pub/restaurant, village hall, tea rooms, and more. With easy access to the A19 and A1, Jasmine Cottage is a rare gem in an idyllic setting, ready to welcome its new owners.



Floor Plan

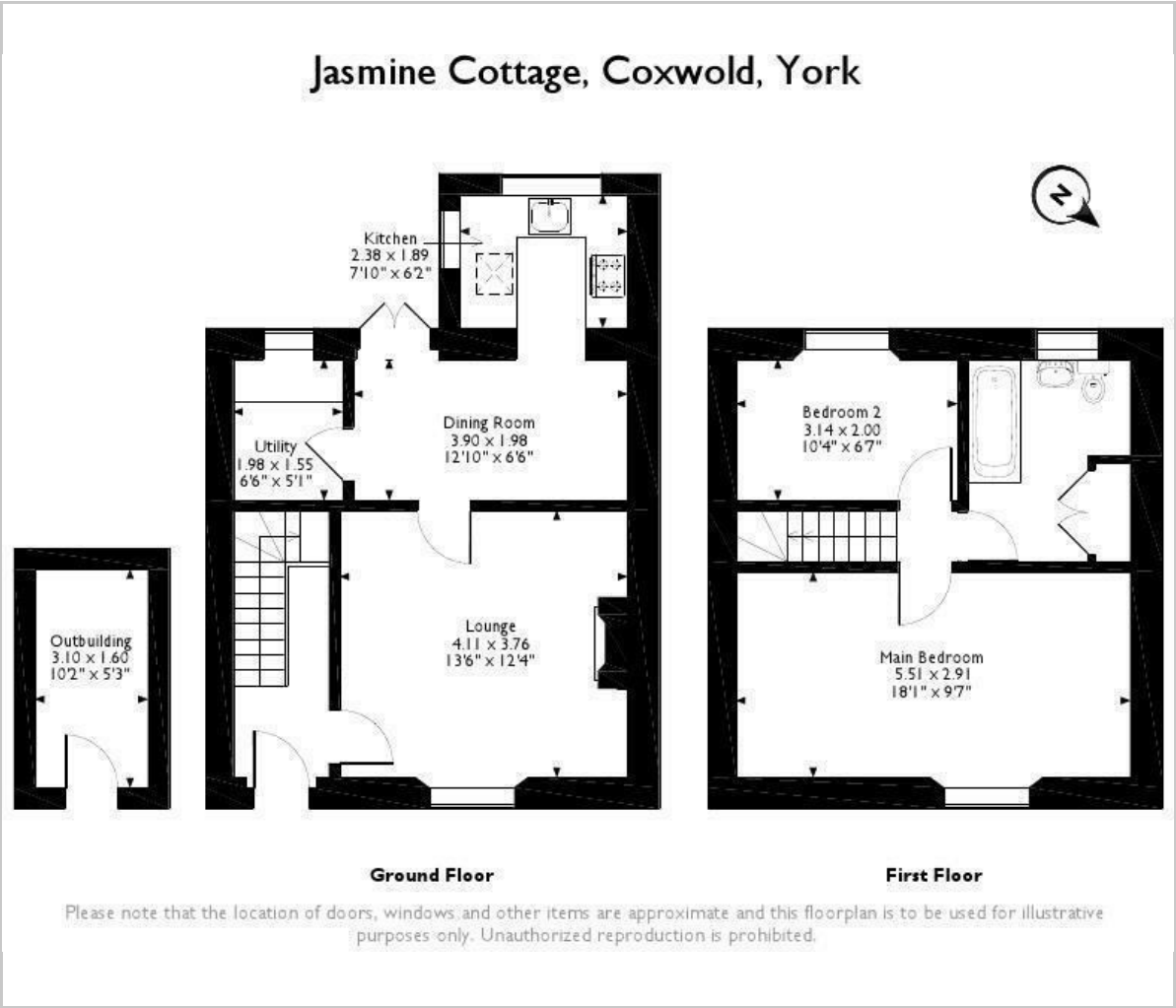

Viewing

Please contact our Emsley Mavor Estate Agents Office on 01347823579 if you wish to arrange a viewing appointment for this property or require further information.

Area Map



Energy Efficiency Graph

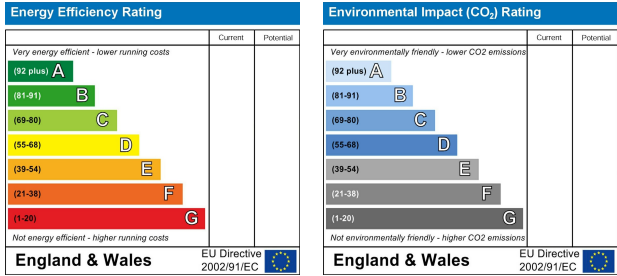

These particulars, whilst believed to be accurate are set out as a general outline only for guidance and do not constitute any part of an offer or contract. Intending purchasers should not rely on them as statements of representation of fact, but must satisfy themselves by inspection or otherwise as to their accuracy. No person in this firms employment has the authority to make or give any representation or warranty in respect of the property.

1 Tollbooth Building Market Place, Easingwold, North Yorkshire, YO61 3AB
Tel: 01347823579 Email: info@emsleymavor.co.uk <http://emsleymavor.co.uk>